



PLAN OF M.R.E. MINING RIGHTS FORFEITED TOWNSHIP NO 5 S.

RANGE 30 EAST OF FIRST MERIDIAN

CROZIER

Scale, 40 Chains to an inch.

CROZIER TOWNSHIP

Vol 57 p. 194

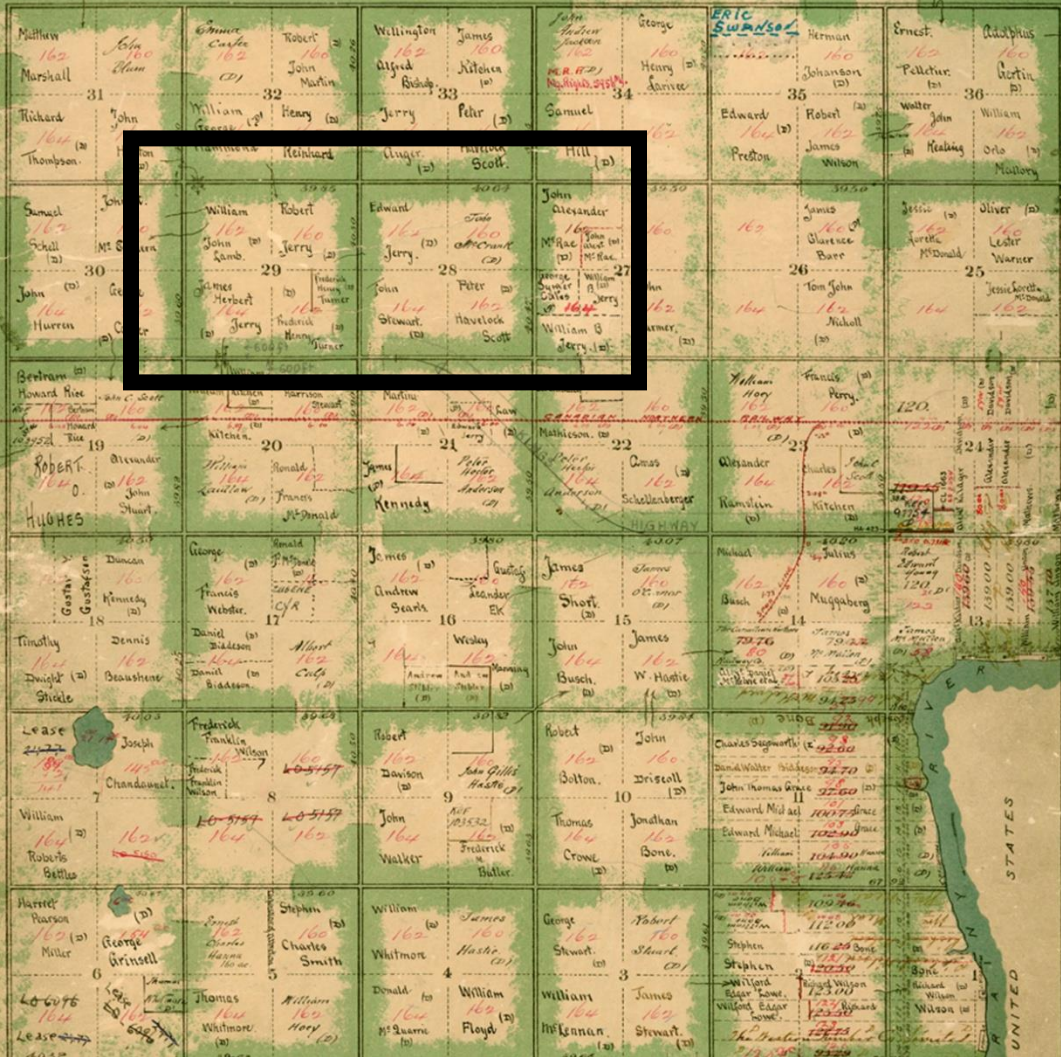

By Order in Council dated Nov 9th 1875, 600 feet on each side of the centre line of certain Highways has been reserved from its position. By Order in Council dated Nov 9th Dec 6th 1875, 100 feet on each side of the centre line of the Highways is vested in the Department of Highways. Limits of reservation shown approx. between.
 From Dept of Highways plan No P2985
 of record in Surveyor's Office, File 121757.
 Surveyed by the Undersigned

C. C. Korner, Dep. Sur.
 August 7th 1876

Dominion Lands Office
 Ottawa

30th August 1876
 Approved and confirmed
C. P. Morris
 Surveyor General

Contents:

Land in Sections	22037.05	Acres
Roads	657.57	"
Water	41.82	"
Total Area	22736.44	"

EXPLANATION OF COLORS:
 Woods:..... Green. Scrub or Prairie and Woods. Dotted green. Water:..... Blue.
 Marshes: Yellow with small strokes of black. Hills or Slopes: Etching or Grey Shade.
 Brulé (Bunt Woods):..... Brown. Settler's Improvements:..... Pink.